

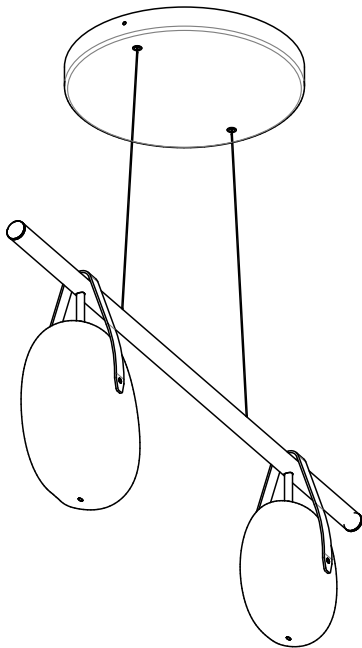

# Gala 42" Chandelier

15738 rA



## CAUTION:

Before starting, turn off power  
at main circuit panel.

## ADVERTENCIA:

Antes de comenzar la instalación,  
apague la corriente en el tablero  
principal.

## ATTENTION:

Coupez l'alimentation avant de  
procéder à l'installation.



Calling for backup? Scan above  
to contact our team.

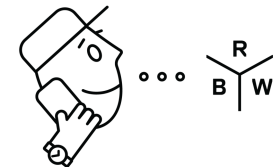
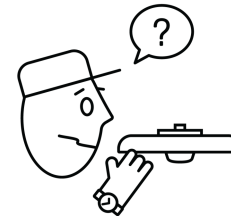

[www.RBW.com](http://www.RBW.com)

+1 212 388 0399

[support@RBW.com](mailto:support@RBW.com)

© RBW Studio LLC, 2013, 2020

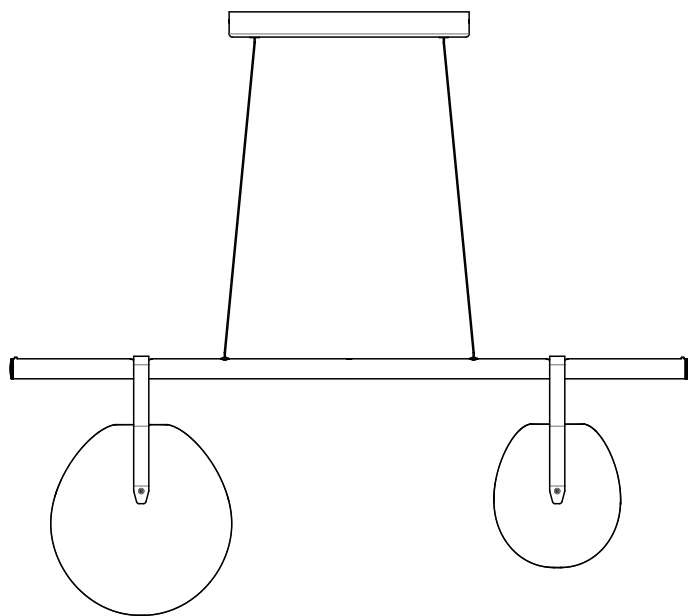

GC-4210

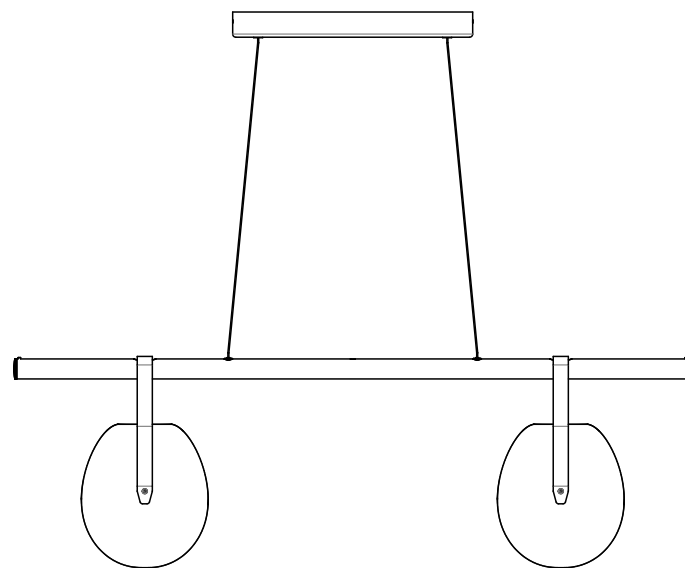

GC-4230

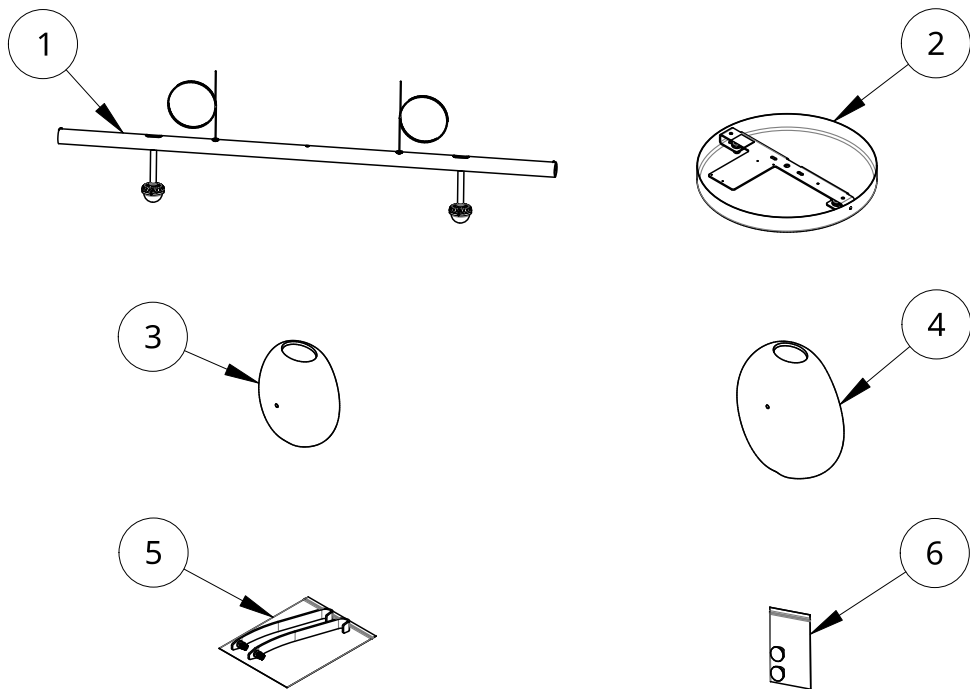

What's Included: Part Configurations May Vary

Item	Qty	Part number	Description
1	1	10481-PC30-22	Assembly: Gala Boom. 42 Packaging. 2200K CCT. Matte Black
2	1	11888-PC30	Package: Gala Chandelier Canopy. Matte Black
3	1	11067	Gala Chandelier Small Globe
4	1	11066	Gala Chandelier Large Globe
5	2	15725-PC30	Assembly: Gala Chandelier Strap Kit. Matte Black
6	1	15727-PC30	Gala End Cap Hardware Kit. Matte Black

Ceiling Surface	Recommended Fastener
Stud-Backed Drywall	#10 Drywall Screw
Hollow Drywall	Molly or Toggle Bolt
Concrete Slab	10-24 Expanding Anchor
Wood	#10 Wood Screw

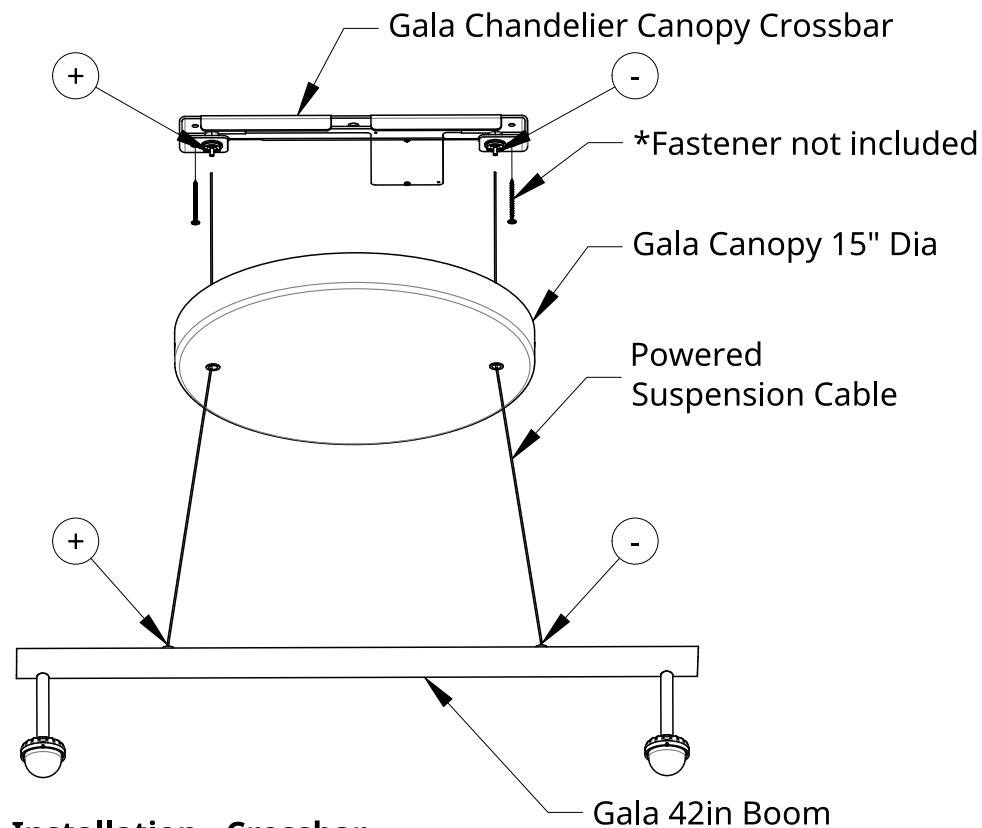

### Installation - Crossbar

1. Mount Crossbar over junction box in desired orientation using recommended fastener.  
Note: +/- Polarity.
2. Feed Powered Suspension Cables through Canopy.  
Note: +/- Polarity.
3. Feed Cables into corresponding Cable Grippers.

See Canopy Install Instructions 15743 for more information

Note: While installing globes, fixture will be off balance and will require a second person to balance the mast until all globes are in place.

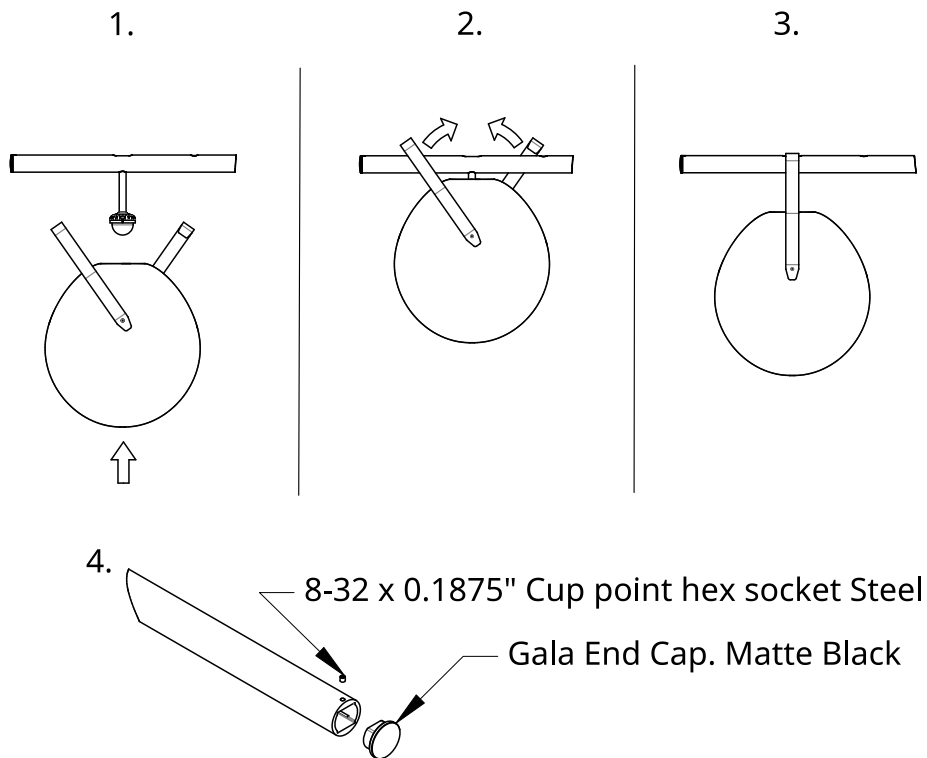

### Installation - Globes and End Caps

1. With Straps attached to Globe and rotated at 45° from vertical, lift Globe upward at light source so Straps extend above Boom.
2. Rotate Straps to their vertical position.
3. Lower Globe until the Straps fit into slot on top of Boom.
4. Fasten Gala End Cap into each open end of fixture via included 8-32 x 0.1875" Set Screws
5. Congratulations! End of guide.

### Gala 42": Install Sequence

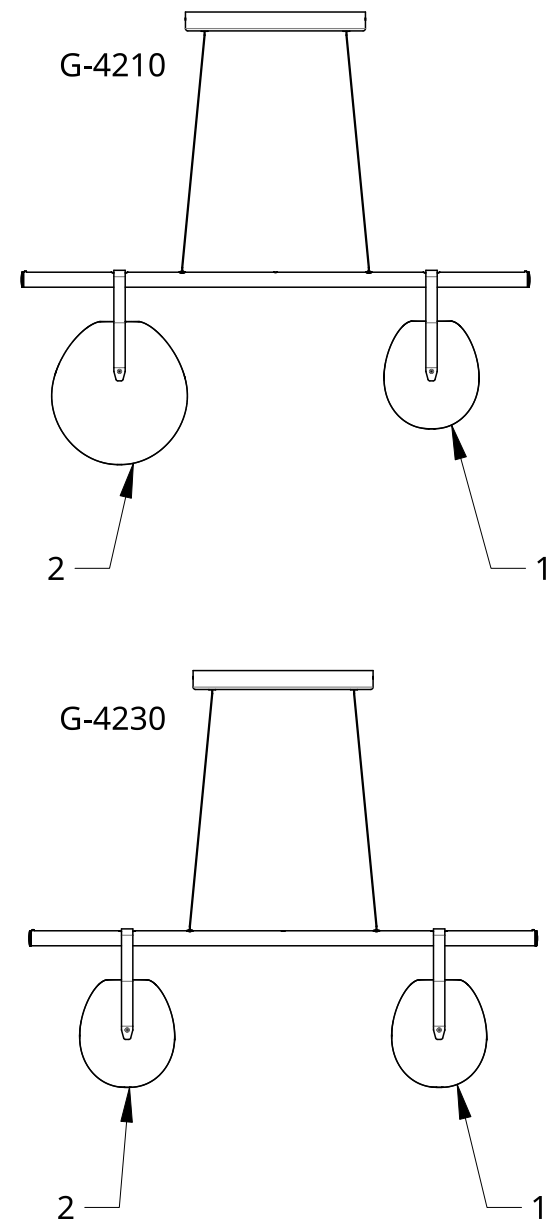

Note: Apply above globe installation steps for all configurations of Gala Chandelier to avoid uneven weight distribution and possible damage.

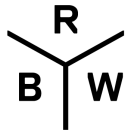

# Gala Chandelier Canopy

15743 rB

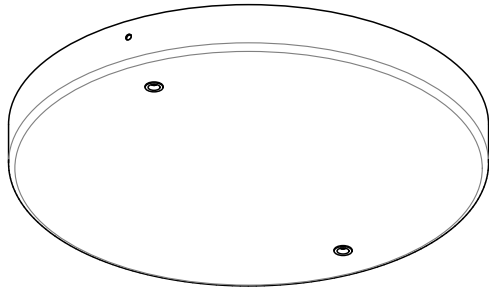

## CAUTION:

Before starting, turn off power  
at main circuit panel.

## ADVERTENCIA:

Antes de comenzar la instalación,  
apague la corriente en el tablero  
principal.

## ATTENTION:

Coupez l'alimentation avant de  
procéder à l'installation.



Calling for backup? Scan above  
to contact our team.

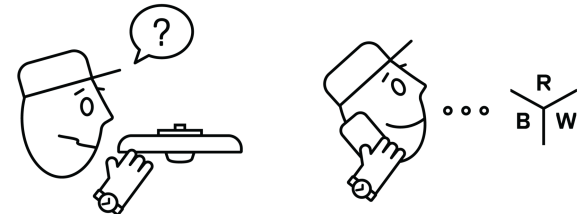

[www.RBW.com](http://www.RBW.com)  
+1 212 388 0399  
[support@RBW.com](mailto:support@RBW.com)  
© 2023, RBW Studio LLC

What's Included: Part Configurations May Vary

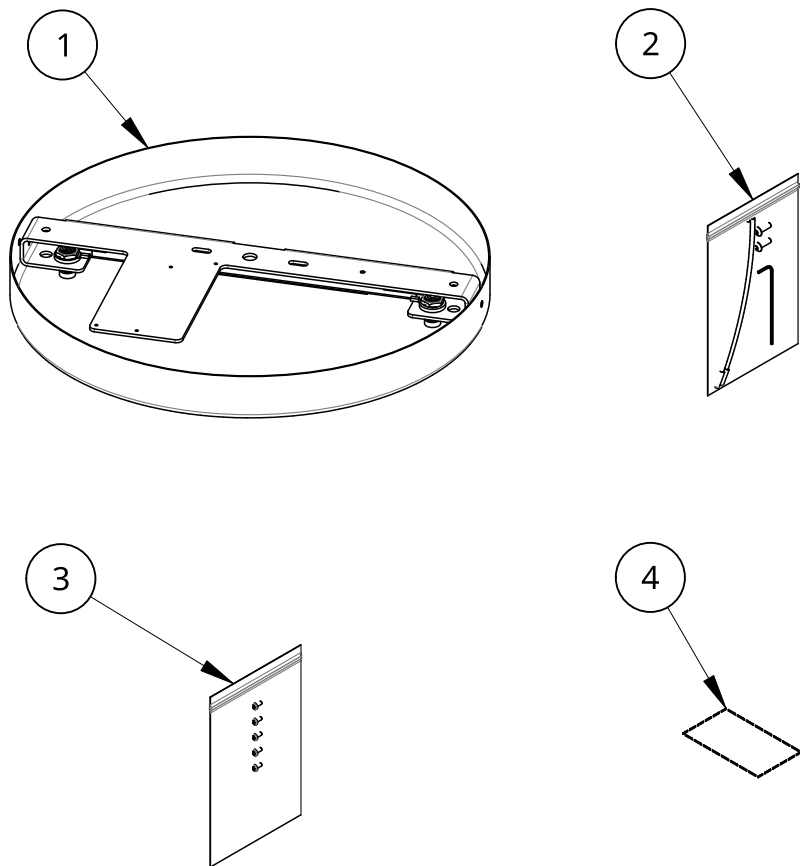

Item	Qty	Description
1	1	Gala Canopy Assembly Black
2	1	Gala Canopy Mounting Kit
3	1	Gala Driver Mounting Screw Kit
4	1	LED Driver

Canopy for 72" Boom must use 600mA Driver

Canopy for 42" Boom must use 400mA Driver

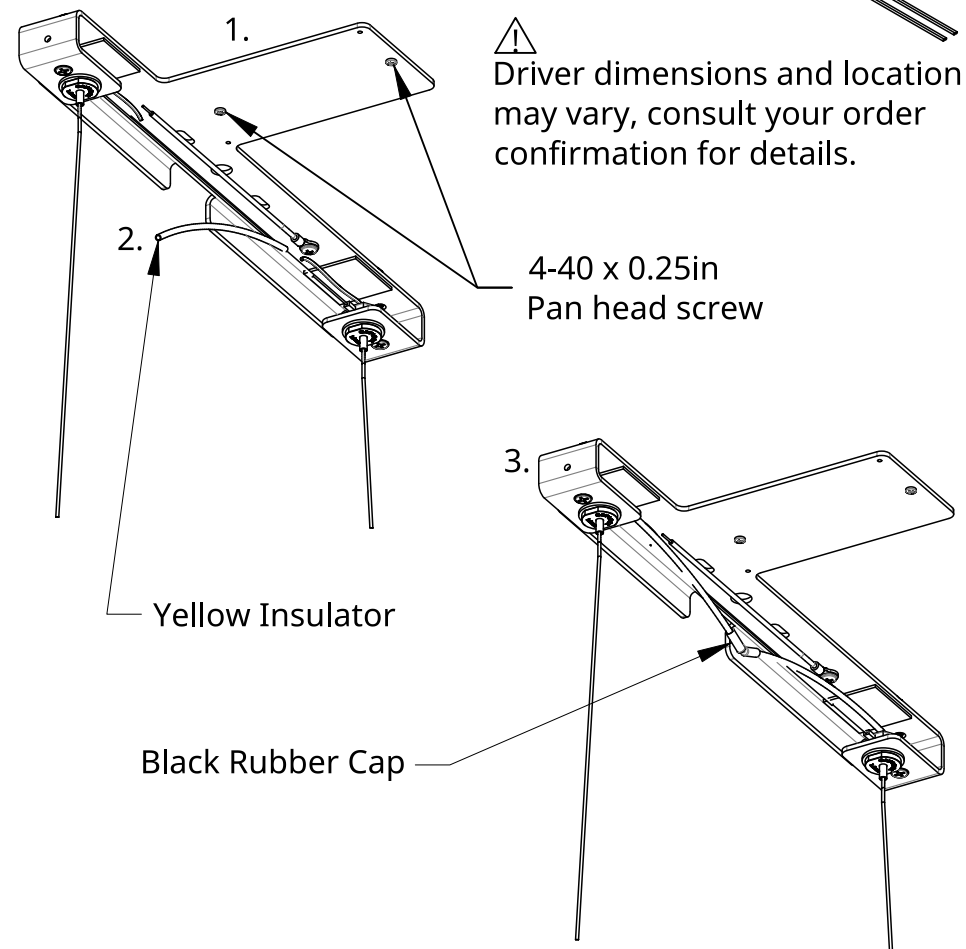

### Installation - Driver and Powered Cables

1. Fasten driver to Crossbar via included 4-40 x 0.25in pan head screws.
2. Adjust fixture to final hang height. Trim excess Cables, slide Yellow Insulators over Cables.
3. Cap Yellow Insulators with Black Rubber Caps.

See chandelier installation instructions for mounting crossbar to substrate.

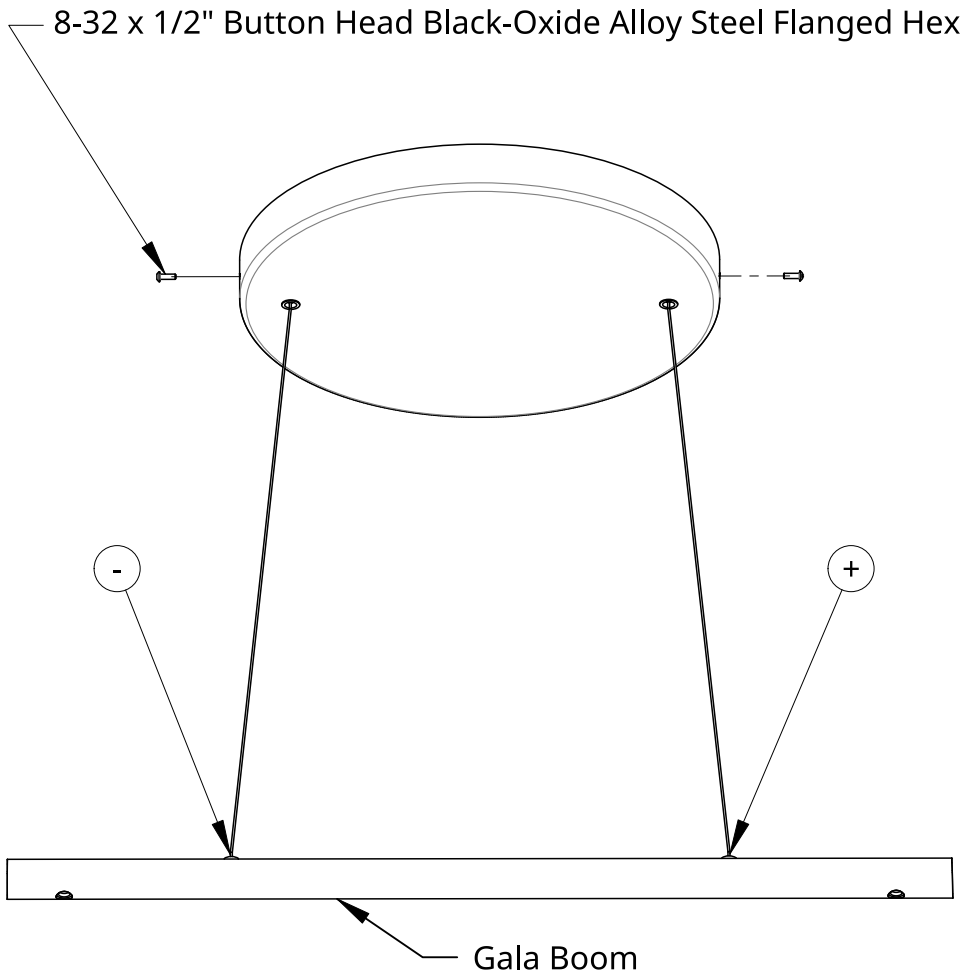

Page Intentionally Left Blank

### Installation - Wiring and Canopy Screws

1. Connect Red (+) and Black (-) leads from driver to red and black leads connected to cable grippers.
2. Connect AC (L) and AC (N) leads from driver to leads in j-box.
3. Connect ground wire from canopy to ground in j-box
4. Slide Canopy upward and cover Crossbar. Secure in place with (2) 8-32 hex screws on either side of Canopy with provided allen key.
5. Congratulations! End of guide.